

Copper Fittings

PRODUCT DESCRIPTION



Full flow, standard radius copper fittings are supplied roll grooved, ready for installation with either Style 606 couplings or Style 641 Vic-Flange® adapters.

Most size 2 - 4" (54,0 - 104,8 mm) fittings are wrought copper. Most size 5 - 8" (130,2 - 206,4 mm) fittings are bronze castings. Currently available configurations are 90° elbows No. 610, 45° elbows No. 611, straight tees No. 620, reducing tees No. 625 grooved and No. 626 "cup," grooved No. 650, grooved X "cup" No. 652 reducers and No. 660 cap. For other configurations and special requirements, consult Victaulic.

Standard Victaulic Vic-Easy® roll grooving tools can be used to field or shop roll groove all grades of copper tubing from 2 - 8" (54,0 - 206,4 mm). The VE26C allows in-place grooving for all types of copper tubing. Tools must be equipped only with Victaulic rolls designed specifically for grooving copper tube (color coded copper). **DO NOT use rolls intended for steel pipe. The use of incorrect rolls will result in improper groove dimensions.**

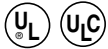

See Victaulic publication 10.01 for details.

DIMENSIONS

Elbows and Tees

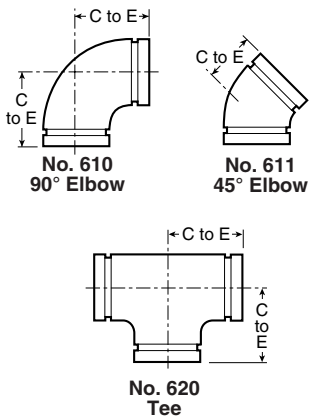

TUBING Inches/millimeters		No. 610 90° Elbow		No. 611 45° Elbow		No. 620 Tee	
Nominal Size	Diameter	C to E Inches millimeters	Aprx. Wgt. Ea. Lbs./kg	C to E Inches millimeters	Aprx. Wgt. Ea. Lbs./kg	C to E Inches millimeters	Aprx. Wgt. Ea. Lbs./kg
2 50	2.125 54,0	2.91 74	0.9 0,4	2.19 56	0.8 0,4	2.69 62	1.1 c 0,5
2 1/2 65	2.625 66,7	3.31 84	1.3 0,6	2.31 59	1.1 0,5	3.20 81	1.8 c 0,8
3 80	3.125 79,4	3.81 97	4.1 c 1,9	2.59 66	1.6 c 0,7	3.52 89	3.2 c 1,5
4 100	4.125 104,8	4.75 121	6.7 c 3,0	3.19 81	3.4 c 1,5	4.25 108	6.1 c 2,8
5 125	5.125 130,2	5.94 151	15.0 c 6,8	3.25 83	10.0 c 4,5	5.94 151	18.5 c 8,4
6 150	6.125 155,6	6.94 176	20.0 c 9,1	3.63 92	13.0 c 5,9	6.94 176	25.5 c 11,6
8 200	8.125 206,4	7.75 197	26.0 c 11,8	4.25 108	15.6 c 7,1	7.75 197	45.0 c 20,4

c = Bronze casting; all others, drawn copper.

DIMENSIONS

Reducing Tees

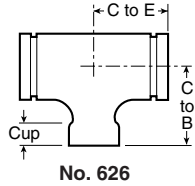
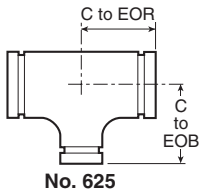

Nominal Size Inches Actual millimeters				No. 625 Grvd. × Grvd. × Grvd.			No. 626 Grvd. × Grvd. × Cup			
				C to E Inches millimeters	C to B Inches millimeters	Aprx. Wgt. Ea. Lbs./kg	C to E Inches millimeters	C to B Inches millimeters	Cup Inches millimeters	Aprx. Wgt. Ea. Lbs./kg
2 54,0	X	2 54,0	X 3/4	-	-	-	2.20	1.98	0.75	0.75
			X 22,2	-	-	-	56	50	19	0,3
	X	X 1	-	-	-	2.33	2.20	0.91	0.81	
		X 28,6	-	-	-	59	56	23	0,4	
		X 1 1/4	-	-	-	2.48	2.35	0.97	0.85	
		X 34,9	-	-	-	63	60	25	0,4	
X	X 1 1/2	-	-	-	2.55	2.28	1.09	0.87		
	X 41,3	-	-	-	65	58	28	0,4		
2 1/2 66,7	X	2 1/2 66,7	X 1	-	-	-	2.40	2.40	0.91	1.17
			X 28,6	-	-	-	61	61	23	0,5
	X	X 1 1/4	-	-	-	2.52	2.57	0.97	1.23	
		X 34,9	-	-	-	64	65	25	0,5	
		X 1 1/2	-	-	-	2.70	2.68	1.09	1.32	
		X 41,3	-	-	-	69	68	28	0,6	
X	X 2	3.28	3.38	1.58	-	-	-	-		
	X 54,0	83	86	0.7	-	-	-	-		
3 79,4	X	3 79,4	X 1	-	-	-	2.54	2.79	0.91	1.45
			X 28,6	-	-	-	65	71	23	0,7
	X	X 1 1/4	-	-	-	2.63	2.89	0.97	1.74	
		X 34,9	-	-	-	67	73	25	0,8	
		X 1 1/2	-	-	-	2.85	3.00	1.09	1.74	
		X 41,3	-	-	-	72	76	28	0,8	
X	X 2	3.00	3.38	2.14 c	-	-	-	-		
	X 54,0	76	86	1.0	-	-	-	-		
X	X 2 1/2	3.25	3.50	2.43 c	-	-	-	-		
	X 66,7	83	89	1.1	-	-	-	-		
4 104,8	X	4 104,8	X 1	-	-	-	3.10	3.22	0.91	2.86
			X 28,6	-	-	-	79	82	23	1,3
	X	X 1 1/4	-	-	-	3.25	3.47	0.97	3.03	
		X 34,9	-	-	-	83	88	25	1,4	
		X 1 1/2	-	-	-	3.35	3.65	1.09	3.16	
		X 41,3	-	-	-	85	93	28	1,4	
X	X 2	3.66	4.13	5.25 c	-	-	-	-		
	X 54,0	93	105	2.4	-	-	-	-		
X	X 2 1/2	3.94	4.06	5.75 c	-	-	-	-		
	X 66,7	100	103	2.6	-	-	-	-		
X	X 3	4.19	4.16	6.25 c	-	-	-	-		
	X 79,4	106	106	2.8	-	-	-	-		
5 130,2	X	5 130,2	X 3	3.75	4.63	5.41 c	-	-	-	-
			X 79,4	95	118	2.5	-	-	-	-
	X	X 2 1/2	4.25	4.56	8.75 c	-	-	-	-	
6 155,6	X	6 155,6	X 2 1/2	3.63	5.13	6.66 c	-	-	-	-
			X 66,7	92	130	3.0	-	-	-	-
	X	X 3	3.69	5.19	8.12 c	-	-	-	-	
		X 79,4	94	132	3.7	-	-	-	-	
	X	X 4	4.19	5.13	9.75 c	-	-	-	-	
		X 104,8	106	130	4.4	-	-	-	-	
X	X 5	4.69	5.19	11.25 c	-	-	-	-		
X 130,2	119	132	5.1	-	-	-	-			

c = Bronze casting; all others, drawn copper

Cap



No. 660

No. 660 Cap			
Nominal Size Inches/mm	Diameter Inches/mm	Thickness - T Inches/mm	Aprx. Weight Each Lbs./kg
2 50	2.125	0.96	1.2 c
	54,0	24	0.5
2 1/2 65	2.625	0.96	1.4 c
	66,7	24	0.6
3 80	3.125	0.96	1.4 c
	79,4	24	0.6
4 100	4.125	0.96	2.4 c
	104,8	24	1,1
5 125	5.125	0.96	3.5 c
	130,2	24	1,6
6 150	6.125	0.96	4.2 c
	155,6	24	1,9

c = Bronze casting

DIMENSIONS

Reducers

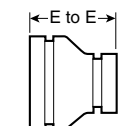

No. 650

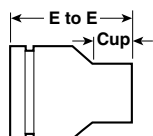

No. 652

Nominal Size Inches Actual millimeters	No. 650 Grooved X Grooved		No. 652 Grooved X Cup		
	E to E Inches millimeters	Aprx. Wgt. Ea. Lbs. kg	E to E Inches millimeters	Cup Inches millimeters	Aprx. Wgt. Ea. Lbs. kg
2 54,0	X 1	–	–	–	–
	X 28,6	–	–	–	–
	X 1 1/4	–	–	–	–
	X 34,9	–	–	–	–
2 1/2 66,7	X 1 1/2	–	–	–	–
	X 41,3	–	–	–	–
	X 1	–	–	–	–
	X 28,6	–	–	–	–
3 79,4	X 1 1/4	–	–	–	–
	X 34,9	–	–	–	–
	X 1 1/2	–	–	–	–
	X 41,3	–	–	–	–
4 104,8	X 2	3,29	1,00	3,30	1,34
	X 54,0	83	0,5	84	34
	X 1 1/2	–	–	–	–
	X 41,3	–	–	–	–
5 130,2	X 3	3,88	6,30	–	–
	X 79,4	99	2,9	–	–
	X 4	3,38	6,30 c	–	–
	X 104,8	86	2,9	–	–
6 155,6	X 3	4,38	6,40 c	–	–
	X 79,4	111	2,9	–	–
	X 4	3,88	6,50 c	–	–
	X 104,8	99	2,9	–	–
8 206,4	X 5	3,38	6,70 c	–	–
	X 130,2	86	3,0	–	–
	X 6	5,00	10,0 c	–	–
	X 155,6	127	4,5	–	–

c = Bronze casting; all others, drawn copper

MATERIAL SPECIFICATIONS

Copper Fittings: Wrought copper per ASTM B-75 C12200 or ASTM B-152 C11000* and ANSI B 16.22, or bronze sand casting per ASTM B-584-87 copper alloy CDA 836 (85-5-5-5) per ANSI B 16.18.

*Applies to 6" X 4" No. 650 Reducer only.